

R/S = IRON PIN SET
 O/S = IRON PIPE FOUND
 C/L = CENTER LINE EQUIPMENT
 R/W = RIGHT OF WAY
 F.F.E. = FINISH FLOOR ELEVATION
 TBM = TRANSIT BENCH MARK
 E = OVERBORN POWER LINE

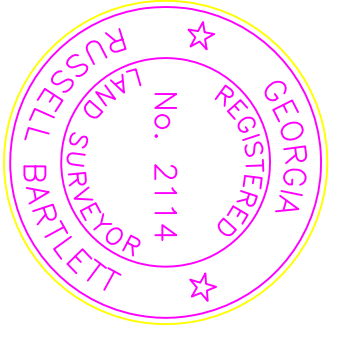

THIS SURVEY MADE WITH A TOPCON TOTAL STATION HAS A CLOSURE PRECISION OF ONE FOOT IN 25789 FEET AND AN ANGLE ERROR OF 0.70" PER ANGLE POINT. THIS PLAT HAS BEEN CALCULATED FOR CLOSURE AND IS FOUND TO BE ACCURATE WITHIN ONE FOOT IN 4 FEET.

SURVEYED BY: JAMES R. BARTLETT
 RUSSELL N. BARTLETT
 R/S NO. 2114, LWS R/S NO. 2539
 MARTIN, GA. 30557
 (706) 779-5047

TOPOGRAPHY SURVEY FOR:
**TOCCOA-STEPHENS COUNTY
 FOUNDATION, INC.**

COUNTY: STEPHENS, GEORGIA
 GND: 440
 DATE: 23-FEB-2010 MAPPED: 01-MAR-2010
 SCALE: 1" = 50'
 JOB: 350PB
 FILE: TOCCOA-STEPHENS CO. FOUNDATION

